



Marina, St. Leonards-On-Sea TN38 0BG

Offers in excess of £200,000



A well presented ONE BEDROOM APARTMENT with PRIVATE BALCONY and panoramic sea views. Occupying a PRIME SEAFRONT LOCATION this fantastic property is ideally located for life at the coast, it's within immediate walking distance of the beach and the hub of St. Leonards On Sea where there are local, independent shops, award winning eateries and galleries along with a mainline railway station with connections to London. The accommodation here enjoys GENEROUS PROPORTIONS with a large OPEN PLAN LIVING SPACE which benefits from a front aspect framing STUNNING COASTAL VIEWS and leads through to the MODERN FITTED KITCHEN where there is ample storage and worktop space. The DOUBLE BEDROOM enjoys doors leading out to the balcony while the bathroom sits at the rear. Being sold with NO ONWARD CHAIN, this fantastic property would make the PERFECT SEASIDE RETREAT and is not to be missed.

FIRST FLOOR
590 sq.ft. (54.8 sq.m.) approx.

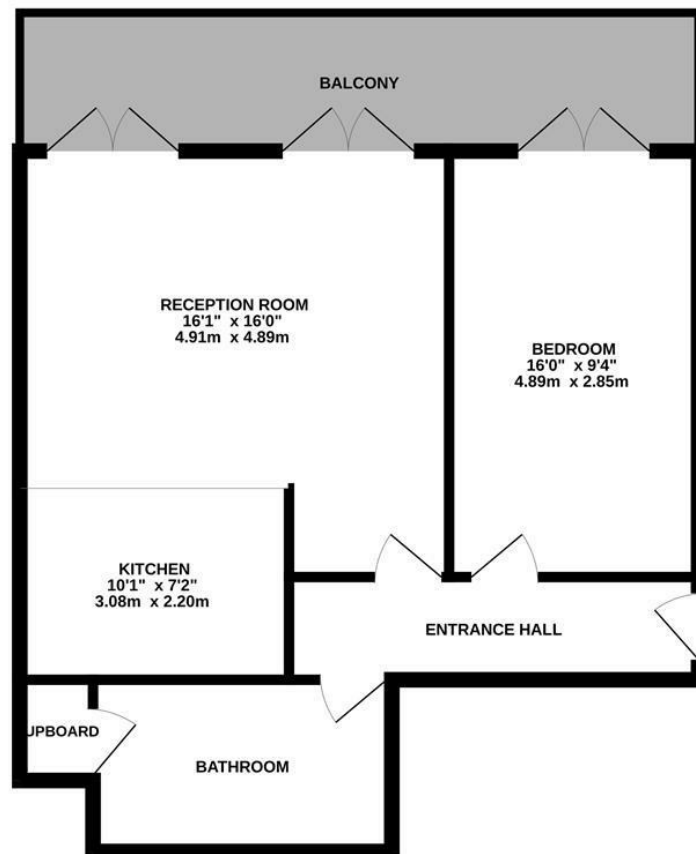

TOTAL FLOOR AREA : 590 sq.ft. (54.8 sq.m.) approx.
Whilst every attempt has been made to ensure the accuracy of the floorplan contained here, measurements of doors, windows, rooms and any other items are approximate and no responsibility is taken for any error, omission or mis-statement. This plan is for illustrative purposes only and should be used as such by any prospective purchaser. The services, systems and appliances shown have not been tested and no guarantee as to their operability or efficiency can be given.
Made with Metropix ©2024

